

**FL150 AND FL150V "FLEX-LOC" GAS COOLED**

RATING @ 100% DUTY CYCLE: 150 AMP ACHF OR DCSP

HEAD ACCESSORIES: 3 SERIES (10NXX SERIES) (SEE PAGE 50)

POWER CABLE ADAPTOR: 15PCA (105Z57)

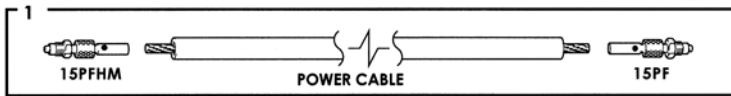
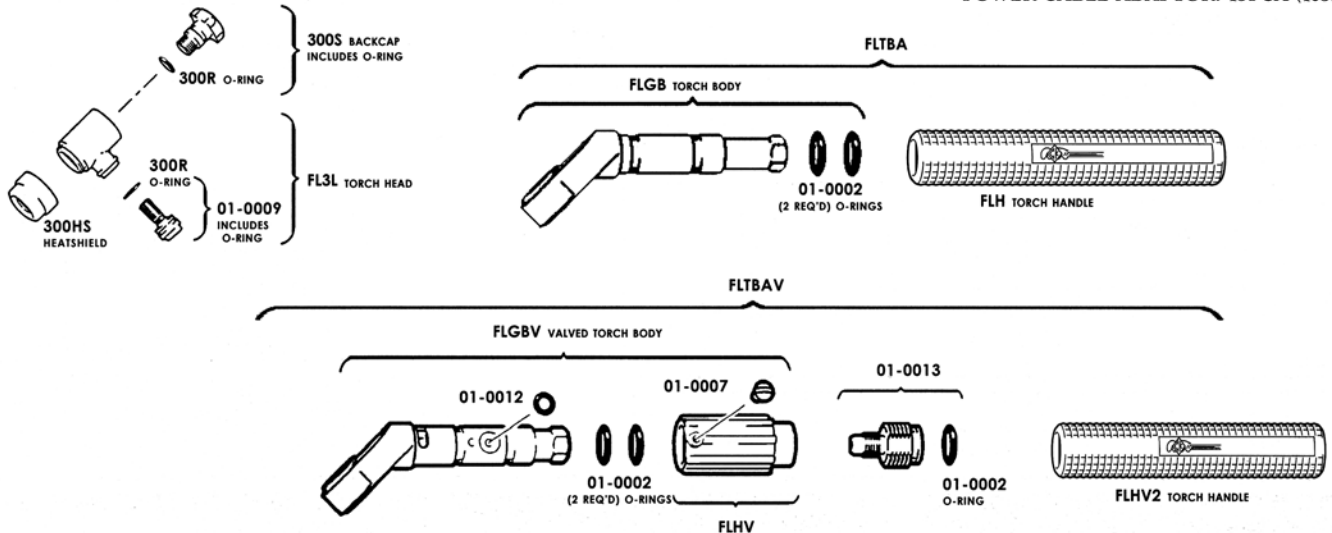

	STANDARD CABLES	SUPERFLEX CABLES
1	<b>1 PIECE POWER CABLE</b>	<b>1 PIECE POWER CABLE</b>
	12-1/2 FT (3.8M): 1512PCHFM	12-1/2 FT (3.8M): 1512PCSFM
	25 FT (7.6M): 1525PCHFM	25 FT (7.6M): 1525PCSFM

**CK210 AND CK210V RIGID GAS COOLED**

RATING @ 100% DUTY CYCLE: 200 AMP ACHF OR DCSP

HEAD ACCESSORIES: 3 SERIES (10NXX SERIES) (SEE PAGE 50)

POWER CABLE ADAPTOR: 21HPCA (2310-1879)

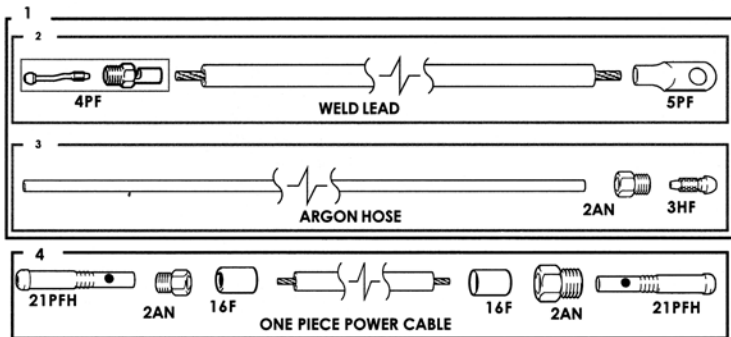
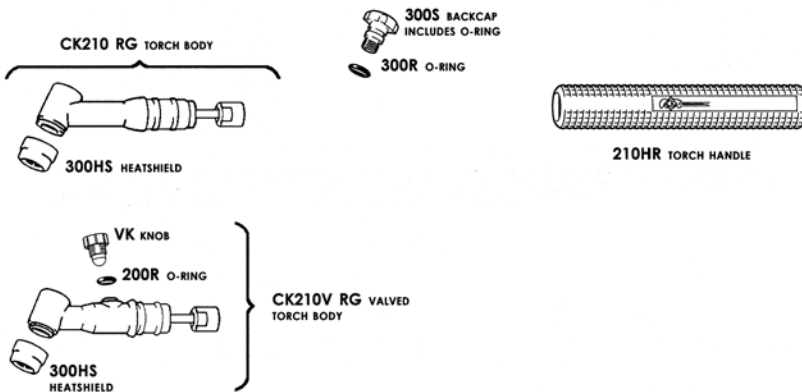

	STANDARD CABLES	SUPERFLEX CABLES
1	<b>2 PIECE POWER CABLES</b>	<b>2 PIECE POWER CABLES</b>
	12-1/2 FT (3.8M): 412PCN	12-1/2 FT (3.8M): 412PCNSF
	25 FT (7.6M): 425PCN	25 FT (7.6M): 425PCNSF
2	<b>WELD LEAD</b>	
	12-1/2 FT (3.8M): 412CN	
3	<b>ARGON HOSE</b>	
	12-1/2 FT (3.8M): 312AH	12-1/2 FT (3.8M): 312AHSF
4	<b>1 PIECE POWER CABLE</b>	<b>1 PIECE POWER CABLE</b>
	12-1/2 FT (3.8M): 412PCHF	12-1/2 FT (3.8M): 412PCSF
	25 FT (7.6M): 425PCHF	25 FT (7.6M): 425PCSF