



THE STANDARD IN TIG WELDING

AMPTRAK Linear Amperage Control



The Amptrak remote current control provides remote on/off control of the welding machine contactor and/or gas and water solenoid control, as well as full range remote current output control. A built-in strain-relief prevents the control cord from being pulled out or damaged. The Amptrak remote current control can be ordered either built into a CK torch handle as original equipment, as a clip-on unit for retrofit to an existing TIG torch or SMAW (stick) electrode holder, or in the Velcro™ model where one size fits all.



VELCRO™ STRAPS



BUILT-IN HANDLE
(for CK torches)

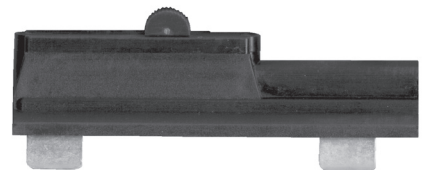

METAL CLIPS

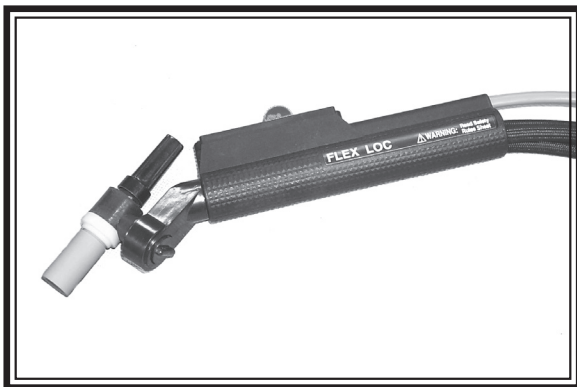

See your local welding supply distributor for CK Worldwide's many other amperage control options!

Quality TIG Welding Torches and Accessories

CK AMPTRAK MODELS

BUILT-IN HANDLE (FOR CK TORCHES)

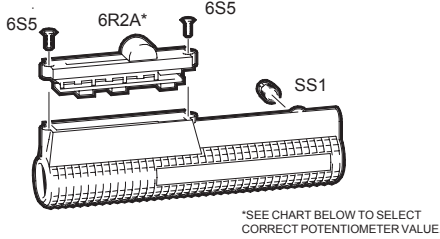

| HANDLE ORDER NUMBER FOR CK TORCHES | | |
|---|---|--|
| 200HE | 230HE | 300HE |
| CK9, CK17, CK20, CK24, CK24W, CK80, CK90, CK100, CK130, CK150, CKC150*, CK200, CK200, FLEX-LOC* | CK230, CKA10, CKA20, TL18, TL26, TL210, TL300 | CK18, CK26, CK210, CK300, CK350, CK510 |

INCLUDES (2) 6S5 & (1) SS1

* ONLY THE CLIPPER VELCRO MODEL WILL WORK WITH THE VALVED KKC150 AND THE VALVED FLEX-LOC TORCHES.

METAL CLIPPER

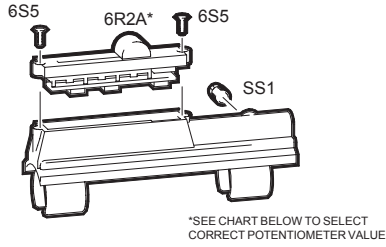

| HANDLE ORDER NUMBER | | |
|--|--|--|
| AMTCS | AMTCM | AMTCL |
| 5/8" - 7/8" (16-22 mm) HANDLE DIAMETER | 7/8" - 1-1/8" (22-29 mm) HANDLE DIAMETER | 1-1/8" - 1-3/8" (29-35 mm) HANDLE DIAMETER |

INCLUDES (2) 6S5 & (1) SS1

VELCRO™ STRAPS

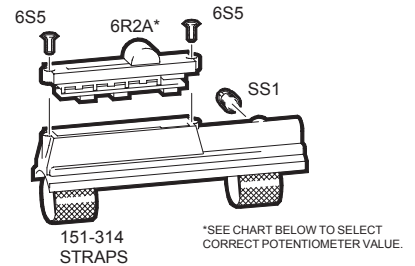

151-314 STRAPS

| HANDLE ORDER NUMBER |
|---------------------|
| AMTCV |
| ONE SIZE FITS ALL |

INCLUDES (2) 6S5 & (1) SS1

PLUG AND CABLE

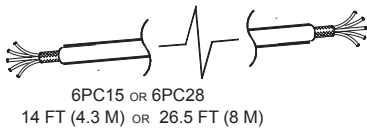

6P (SPECIFY MACHINE)
(i.e. 6P-M14-M FOR MILLER 14 PIN PLUG)

ON/OFF RESISTANCE ADJUSTMENT

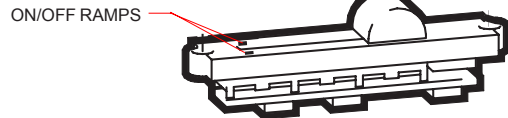

IF THE ON/OFF BUTTON DOES NOT SMOOTHLY MOVE FORWARD, REMOVE A SMALL PORTION OF THE ON/OFF RAMP TO LESSEN THE RESISTANCE. THIS WILL CREATE A SMOOTH MOVEMENT FOR ARC INITIATION AND UP SLOPE. (NOTE: THE RAMPS WILL WEAR OVER TIME DUE TO FRICTION, LESSENING THE RESISTANCE.)

AMPTRAK BUTTON PARTS

REPLACEMENT BUTTONS

- BUTTON-AT-B (BLUE)
- BUTTON-AT-R (RED)
- BUTTON-AT-Y (YELLOW)
- BUTTON-AT-G (GREEN)

REPLACEMENT PIN TO HOLD BUTTON

BUTTON-PIN

AMPTRAK ACCESSORIES

25' AMPTRAK EXTENSION CABLES

- AMTX-____ (PLUG TYPE)
- EXAMPLE AMTX-M14
- FOR MILLER 14 PIN MACHINES

REPLACEMENT 6R2A ASSEMBLY

REPLACEMENT POTENTIOMETER

- 6R2A-1K (1K OHM POT. BLUE)
- 6R2A-5K (5K OHM POT. RED)
- 6R2A-10K (10K OHM POT. YELLOW)
- 6R2A-25K (25K OHM POT. GREEN)

MACHINE PLUG TYPES

| MACHINE AND PLUG CONFIGURATION | PLUG TYPE | MACHINE AND PLUG CONFIGURATION | PLUG TYPE | MACHINE AND PLUG CONFIGURATION | PLUG TYPE |
|--------------------------------|-----------|--------------------------------|-----------|--------------------------------|-----------|
| AIRCO 6 FLAT PRONG SQUARE | 6P-AJPM | KEMPI 4 PIN PIG-TAIL | 6P-K104-M | MILLER 5 PIN PLUG | 6P-M5-M |
| AIRCO 12 PIN PLUG | 6P-A12-M | KEMPI 10 PIN PIG-TAIL | 6P-K104-M | MILLER 14 PIN PLUG | 6P-M14-M |
| AIRCO 3 PIN PIG-TAIL | 6P-A412-M | L-TEC 3 PIN AMPERAGE CONTROL | 120-004 | OTC 19 PIN PLUG | 6P-OTC-M |
| AIRCO 2 PIN PIG-TAIL | 6P-A412-M | L-TEC 3 PIN ON/OFF CONTROL | 120-012 | POWCON 7 PIN PLUG | 6P-P7-M |
| ESAB 4 PIN AMPERAGE CONTROL | 120-004 | LINCOLN 5 PIN PLUG | 6P-L5-M | POWCON 14 PIN PLUG | 6P-POW-M |
| ESAB 3 PIN ON/OFF CONTROL | 120-012 | LINCOLN 6 PIN PLUG | 6P-L6-M | POWCON 17 PIN PLUG | 6P-P17-M |
| ESAB 14 PIN PLUG | 6P-E14-M | LINCOLN 14 PIN PLUG | 6P-L14-M | THERMAL 7 PIN PLUG | 6P-TD7-M |
| HOBART 10 PIN PLUG | 6P-H10-M | LINDE 3 PIN AMPERAGE CONTROL | 120-004 | THERMAL 8 PIN PLUG | 6P-TD8-M |
| HOBART 19 PIN PLUG | 6P-H19-M | LINDE 3 PIN ON/OFF CONTROL | 120-012 | THERMAL 14 PIN PLUG | 6P-TD14-M |

WIRING DIAGRAM

6R2A POTENTIOMETER AND SWITCH ASSEMBLY

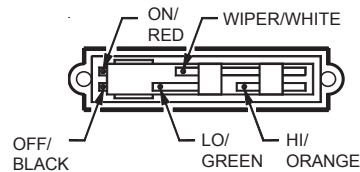

DESCRIPTION OF WIRES AND WIRE COLORS

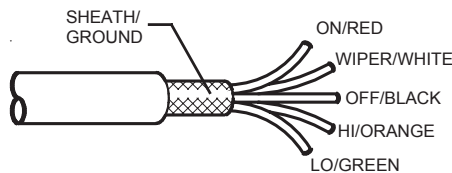

Form No. 9501
August, 2016
CK Worldwide, Inc.
P.O. Box 1636 Auburn, WA. 98071
USA
Ph: (253) 854-5820
Fax: (253) 939-1746