

**CK17 AND CK17V FLEX GAS COOLED**

RATING @ 100% DUTY CYCLE: 150 AMP ACHF OR DCSP

HEAD ACCESSORIES: 3 SERIES (10NXX SERIES) (SEE PAGE 50)

POWER CABLE ADAPTOR: 15PCA (105Z57)

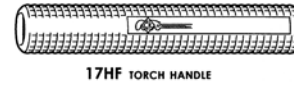
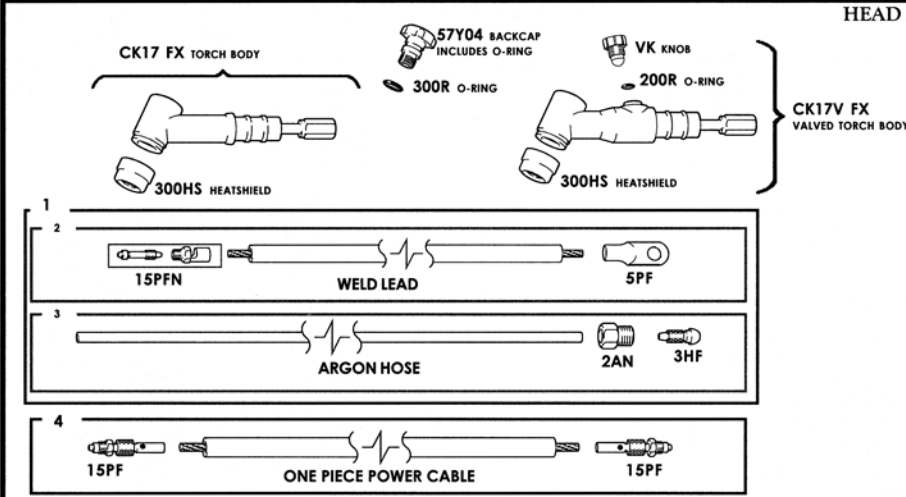

	STANDARD CABLES	SUPERFLEX CABLES
<b>1</b>	<b>2 PIECE POWER CABLES</b>	<b>2 PIECE POWER CABLES</b>
	12-1/2 FT (3.8M): 57Y01-2 25 FT (7.6M): 57Y03-2	12-1/2 FT (3.8M): 57Y01-2SF 25 FT (7.6M): 57Y03-2SF
<b>2</b>	<b>WELD LEAD</b>	
	12-1/2 FT (3.8M): 1512CN 25 FT (7.6M): 1525CN	
<b>3</b>	<b>ARGON HOSE</b>	<b>ARGON HOSE</b>
	12-1/2 FT (3.8M): 45V09 25 FT (7.6M): 45V10	12-1/2 FT (3.8M): 45V09SF 25 FT (7.6M): 45V10SF
<b>4</b>	<b>1 PIECE POWER CABLE</b>	<b>1 PIECE POWER CABLE</b>
	12-1/2 FT (3.8M): 57Y01R 25 FT (7.6M): 57Y03R	12-1/2 FT (3.8M): 57Y01RSF 25 FT (7.6M): 57Y03RSF

**CK24 AND CK24V RIGID GAS COOLED**

RATING @ 100% DUTY CYCLE: 80 AMP ACHF OR DCSP

HEAD ACCESSORIES: 8 SERIES (53NXX SERIES) (SEE PAGE 53)

POWER CABLE ADAPTOR: 1PCA (53N43)

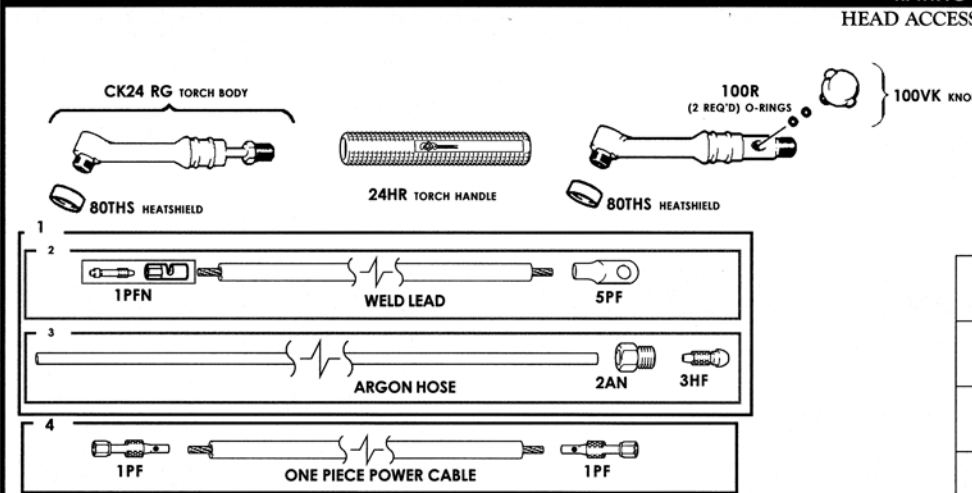

	STANDARD CABLES	SUPERFLEX CABLES
<b>1</b>	<b>2 PIECE POWER CABLES</b>	<b>2 PIECE POWER CABLES</b>
	12-1/2 FT (3.8M): 56Y38-2 25 FT (7.6M): 56Y97-2	12-1/2 FT (3.8M): 56Y38-2SF 25 FT (7.6M): 56Y97-2SF
<b>2</b>	<b>WELD LEAD</b>	
	12-1/2 FT (3.8M): 112CN 25 FT (7.6M): 125CN	
<b>3</b>	<b>ARGON HOSE</b>	<b>ARGON HOSE</b>
	12-1/2 FT (3.8M): 45V09 25 FT (7.6M): 45V10	12-1/2 FT (3.8M): 45V09SF 25 FT (7.6M): 45V10SF
<b>4</b>	<b>1 PIECE POWER CABLE</b>	<b>1 PIECE POWER CABLE</b>
	12-1/2 FT (3.8M): 56Y38R 25 FT (7.6M): 56Y97R	12-1/2 FT (3.8M): 56Y38RSF 25 FT (7.6M): 56Y97RSF

**CK24 AND CK24V FLEX GAS COOLED**

RATING @ 100% DUTY CYCLE: 90 AMP ACHF OR DCSP

HEAD ACCESSORIES: 8 SERIES (53NXX SERIES) (SEE PAGE 53)

POWER CABLE ADAPTOR: 1PCA (53N43)

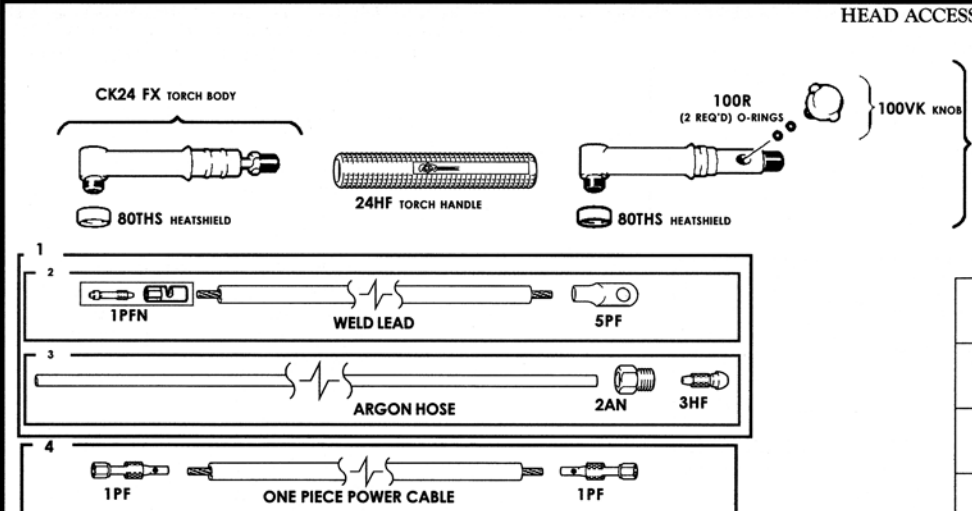

	STANDARD CABLES	SUPERFLEX CABLES
<b>1</b>	<b>2 PIECE POWER CABLES</b>	<b>2 PIECE POWER CABLES</b>
	12-1/2 FT (3.8M): 56Y38-2 25 FT (7.6M): 56Y97-2	12-1/2 FT (3.8M): 56Y38-2SF 25 FT (7.6M): 56Y97-2SF
<b>2</b>	<b>WELD LEAD</b>	
	12-1/2 FT (3.8M): 112CN 25 FT (7.6M): 125CN	
<b>3</b>	<b>ARGON HOSE</b>	<b>ARGON HOSE</b>
	12-1/2 FT (3.8M): 45V09 25 FT (7.6M): 45V10	12-1/2 FT (3.8M): 45V09SF 25 FT (7.6M): 45V10SF
<b>4</b>	<b>1 PIECE POWER CABLE</b>	<b>1 PIECE POWER CABLE</b>
	12-1/2 FT (3.8M): 56Y38R 25 FT (7.6M): 56Y97R	12-1/2 FT (3.8M): 56Y38RSF 25 FT (7.6M): 56Y97RSF